



ROGGIERS
For the Perfection of Football Fundamentals™

PRODUCT INFORMATION PACKET

PRODUCT NAME: MOBILITY CHUTES

PRODUCT PART NUMBER: 410475, 410537

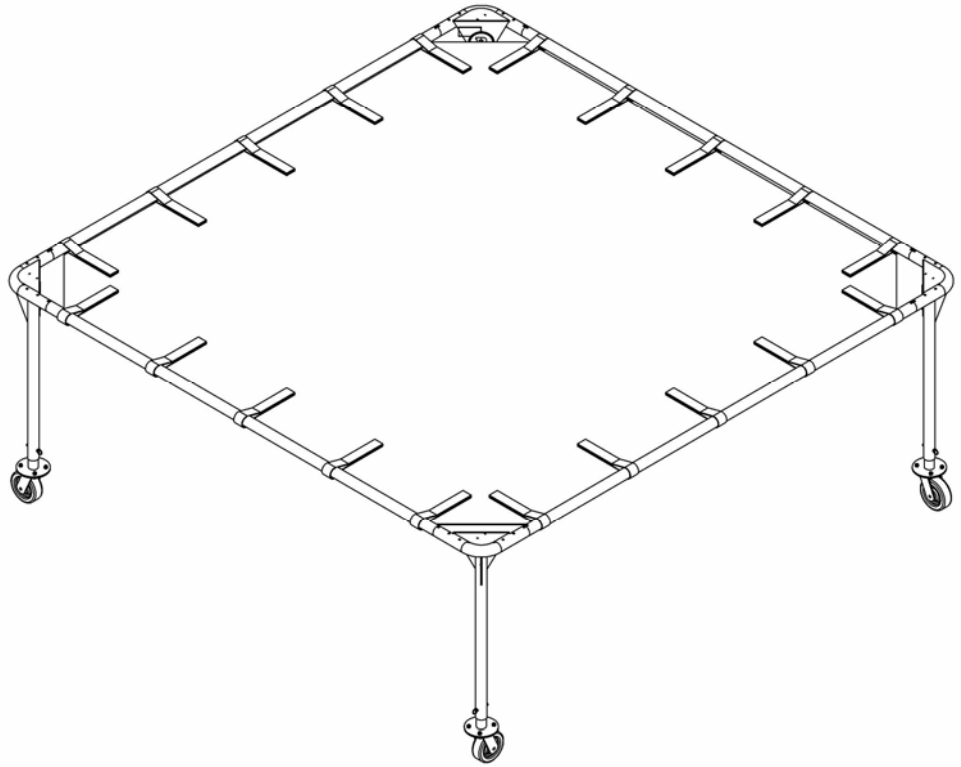

KEEP INFORMATION PACKET FOR FUTURE REFERENCE

TABLE OF CONTENTS

- Introduction.....1
- General Safety Rules.....2
- Symbols.....3
- Technical Specifications.....4
- Assembly Instructions.....5
- Maintenance.....8
- Customer Service Information.....9

INTRODUCTION

The Rogers Athletic Mobility Chute has been designed and manufactured with safety, performance and dependability as top priorities, making it easy to operate and maintain.

The care you give your Mobility Chute will greatly determine your satisfaction with its performance and service life. Careful study of this manual is encouraged to obtain a thorough understanding of your new Mobility Chute and its functions and maintenance.

If your manual becomes lost or destroyed, Rogers Athletic will gladly provide you with a new copy. Should you require additional information or assistance, please feel free to contact us at 1-800-457-5337.

BECAUSE ROGERS ATHLETICS MAINTAINS AN ONGOING PROGRAM OF
PRODUCT DEVELOPMENT AND IMPROVEMENT, WE RESERVE THE RIGHT
TO MAKE IMPROVEMENTS IN DESIGN OR CHANGES IN SPECIFICATIONS
WITHOUT INCURRING ANY OBLIGATIONS TO INSTALL THEM ON UNITS
PREVIOUSLY SOLD.

GENERAL SAFETY RULES



WARNING!



READ AND UNDERSTAND ALL INSTRUCTIONS.

Failure to follow all instructions listed below may result in serious personal injury.

SAVE THESE INSTRUCTIONS

- **Save these instructions.** Refer to them frequently and use them to instruct others who may use the Mobility Chute.
- **Read the Product Information Packet.** Failure to read the information packet is considered a misuse of this equipment.
- **Become familiar with all caution and warning decals affixed to the field equipment before use.**
- **Never cover or deface caution/warning labels.**
- **Use field equipment in a supervised environment.**
- **Stop physical activity if you feel faint, dizzy, or experience pain at any time and consult your physician.**
- **Inspect equipment prior to use. DO NOT use if it appears damaged or inoperable.**
- **Obtain a medical exam prior to beginning any new physical activity.** Use equipment only if properly fit to engage in physical activity.

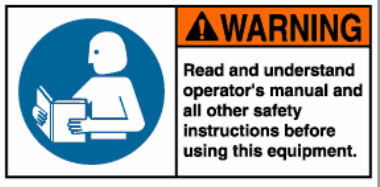
SYMBOLS

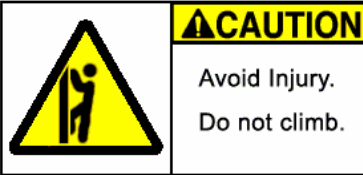
	<p>Safety Alert: Precautions that involve your safety</p>
	<p>Read The Operator's Manual: To reduce risk of injury, user must read and understand operator's manual before using this product</p>
	<p>Pinch Point Symbol: Failure to keep hands away from pinch points will result in personal injury</p>
	<p>Do Not Climb Warning Label: To reduce risk of injury, do not climb on field equipment</p>

ROGERS ATHLETIC FIELD EQUIPMENT SPECIFICATIONS

MOBILITY CHUTES

Description	Part Number	Dimensions (L X W)	Adjustable Height
Mobility Chute	410475	10' x 10'	40" – 69"
Mobility Chute	410537	10' x 20'	40" – 69"

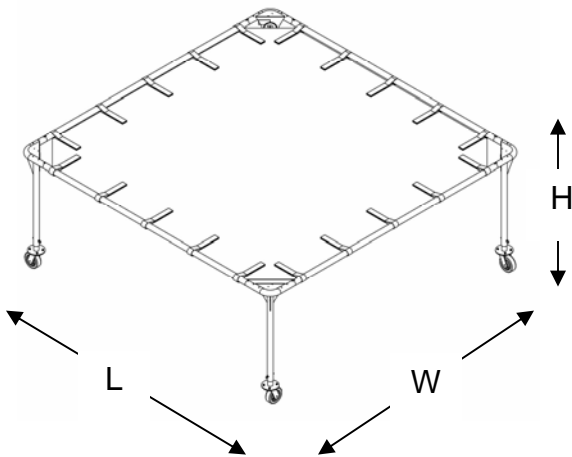

- Designed to teach players to be in a good football hitting position, maintain balance, keep a good pad level and stay low on redirection drills four different ways
- Adjust height without the use of tools from 40" to 69"

Construction, Finish, and Hardware

- Constructed of ASTM specified steel.
- Baked-on powder coat finish.
- Zinc-plated hardware.

ASSEMBLY INSTRUCTIONS

1

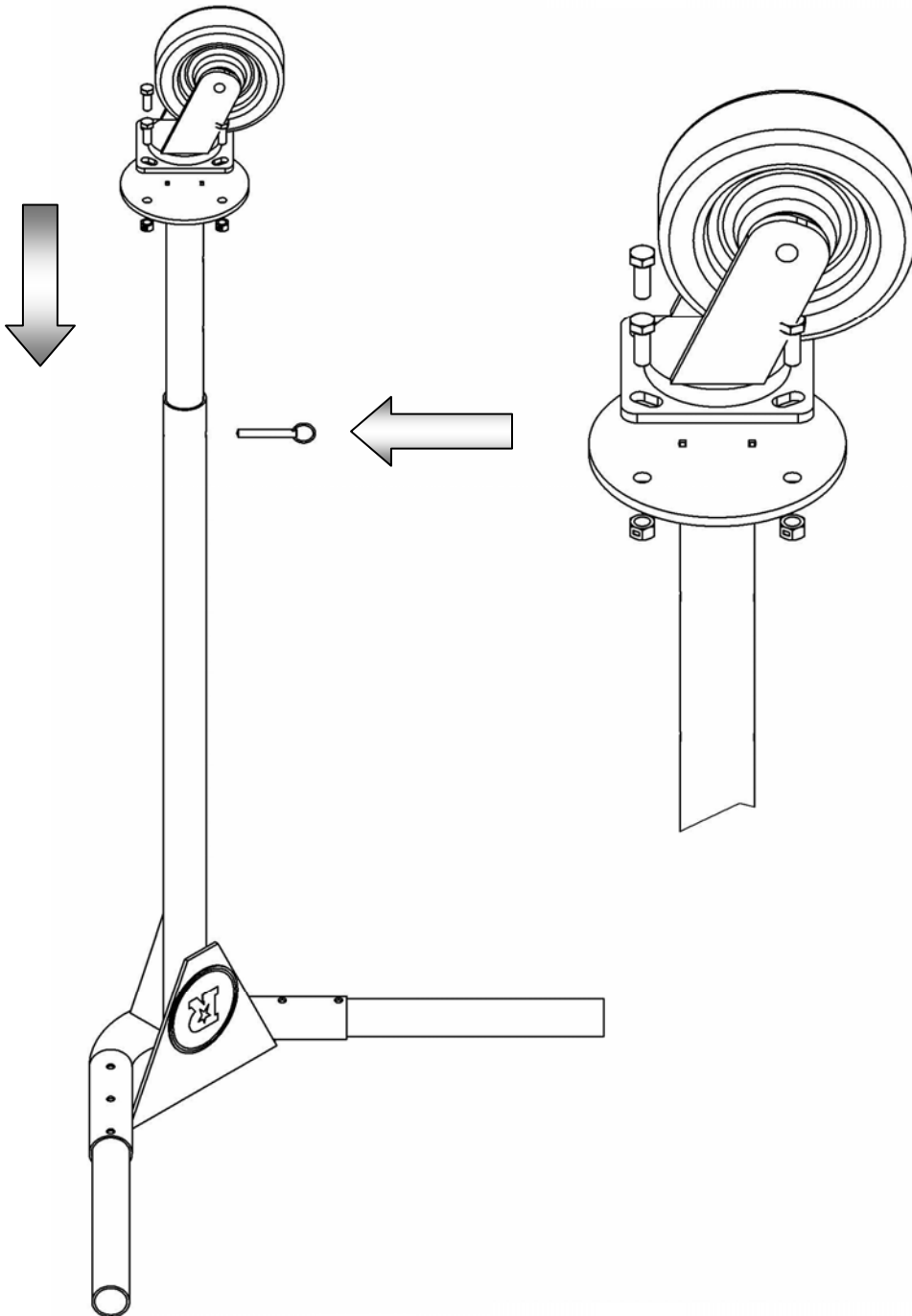

Bolt the casters onto the four leg assemblies using the 3/8" Bolts and Nuts. Insert the leg assemblies into the corner assemblies and lock their position with the given faspins.

2

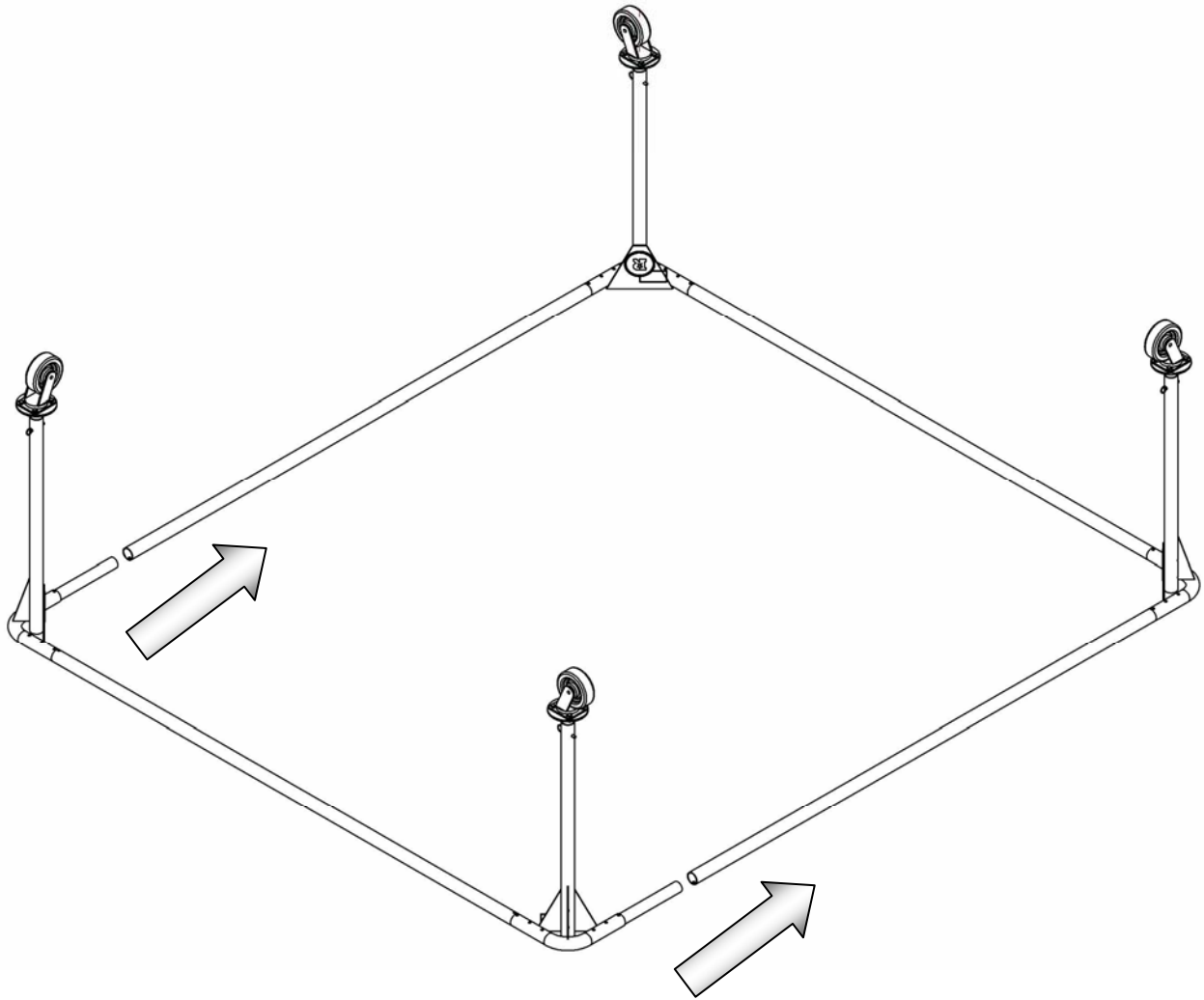

Note: *This step will require two or more people.*

Connect the leg assemblies with the four frame tubes as shown above. Make sure that the leg assemblies are fully inserted into the frame tubes. Once complete, rotate the assembly onto the casters.

3

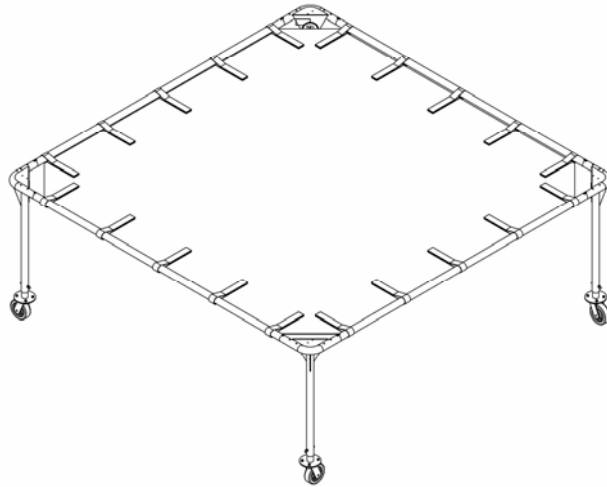

Position the mesh top onto the assembly and fasten it with the Velcro loops.

4

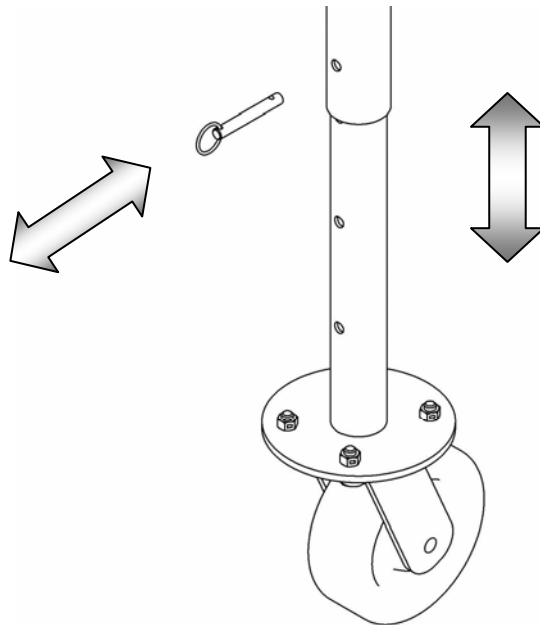

Adjust the height of the Mobility Chute by removing the fast pins from the leg tubes. Raise or lower the tubes to the desired height and reinsert the fast pin. The height can be adjusted from 40" to 69" in 4" increments.

MAINTENANCE



WARNING!

READ AND UNDERSTAND ALL MAINTENANCE PROCEDURES.

Failure to follow all procedures listed below may cause serious injury and a decrease in the equipments functional existence.

- **Frequently check to see that all bolts are securely fastened.**
- **Field equipment should be washed periodically with soapy water to maintain original surface finish.**
- **Touch up paint can be used to cover any scratches or blemishes sustained through use.**
- **A silicone based lubricant may be used on moving parts to maintain proper function.**
- **Replace any damaged equipment with genuine Rogers Athletic parts.** Failure to do so may result in unsafe equipment and/or personal injury.

CUSTOMER SERVICE

For parts or service contact Rogers Athletic Company. When ordering parts be sure to provide all relevant information available including the name and part number of the equipment purchased. This information is located on the cover of this product information package. Customer service hours are Monday through Friday from 8:00 a.m. to 5:00 p.m. Eastern Standard Time. Customers can phone (989) 386-2950 or toll free at (800) 457-5337. Fax toll free at (888) 549-9659 or mail to:

Rogers Athletic Company
3760 W. Ludington Drive
Farwell, Michigan 48622

Rogers Athletic Company
3760 N. Ludington Drive
Farwell, MI 48622
www.rogersathletic.com
(989) 386-2950
(800) 457-5337
Fax toll free (888) 549-9659